

CATTLEMAN INSTALLATION SHEET

2014 TOYOTA TUNDRA

Part # 1527

Installation Kit:

- 6 - 1/2" x 1-1/2" Bolt
- 6 - 1/2" Nut
- 6 - 1/2" Lock Washer
- 12 - 1/2" Flat Washer

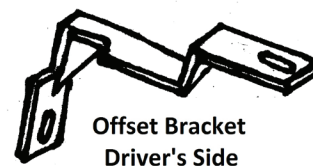
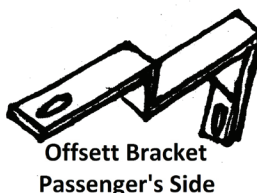
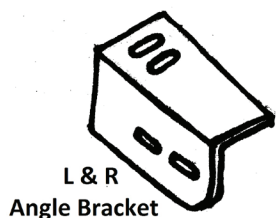

Installation:

STEP 1 - There bolts on the outside of the frame and one bolt on the inside of the frame.

Remove the inside nut on both sides. You may have to unscrew the bottom plastic guard.

Note: Bracket with notch is for the driver side.

STEP 2 - Put offset bracket on the inside bolt as shown.

Put the L side end first. Put it between the bumper and small cooling panel, then work the other end through the opening closer to the end and to the top center of the factory bumper.

STEP 3 - Remove tow hooks put bottom angle bracket on first, then tow hooks use the same factory bolts as shown.

STEP 4 - Put grill guard in place bolt on the bottom angle bracket and top bracket to the center tabs.

STEP 5 - Check alignment and tighten bolts.

STEP 6 - You may need to periodically retighten the bolts.

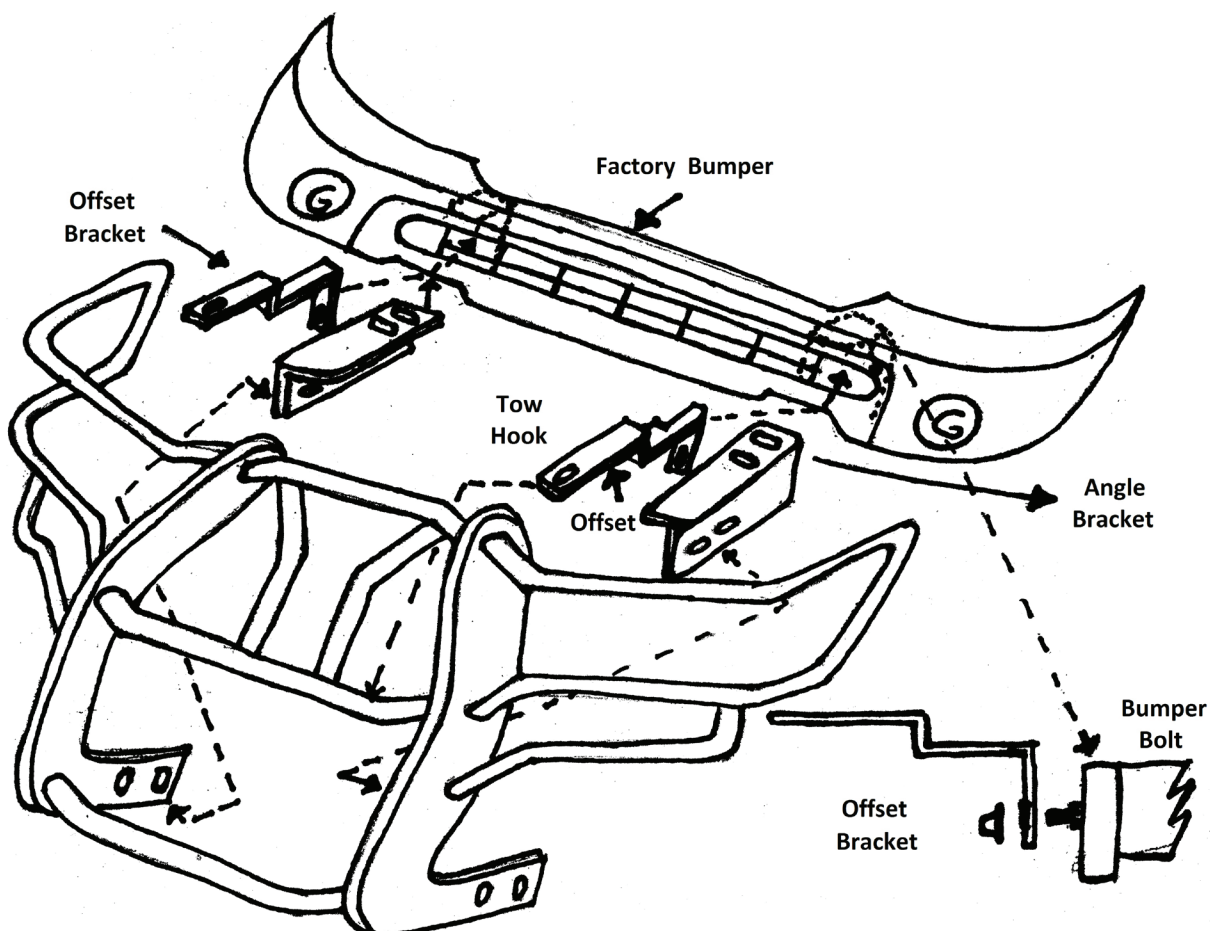

www.cattlemanhd.com

