

CATTLEMAN INSTALLATION SHEET

2015 GMC 2500/3500 HD GRILL GUARD

Part # 1430

Installation Kit:

- 8 - 1/2 x 2" Bolt
- 8 - 1/2 Nut
- 8 - 1/2 Lock Washer
- 16 - 1/2 Flat Washer

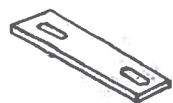

2- Top Bracket

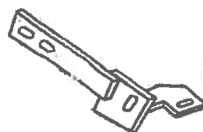

2- Bottom Bracket



2 - Double
"L" Bracket



2 - Square Spacer

Instructions:

Step 1 - Remove Front Grill.

Step 2 - Put Double "L" Bracket to the bumper flat factory bracket, they go on the two inside top bolts. Double "L" Brackets should face in as shown.

Step 3 - Put Top Bracket on the top of the Double "L" Bracket with a square spacer Flat Washer as shown.

Step 4 - For the Bottom Bracket remove tow hooks, put bracket on the outside of the frame. Then, put tow hooks back in place and bolt on with the same factory bolts, one on the side and one on the bottom.

NOTE: Put the Bottom Bracket through the inside out. Driver Side put Bracket from Left to Right and Right to Left and twist to make the bracket go in place.

Step 5 - Put Grill Guard in place.

Step 6 - Check alignment on grill guard and tighten bolts.

Step 7 - You may need to periodically retighten the bolts.

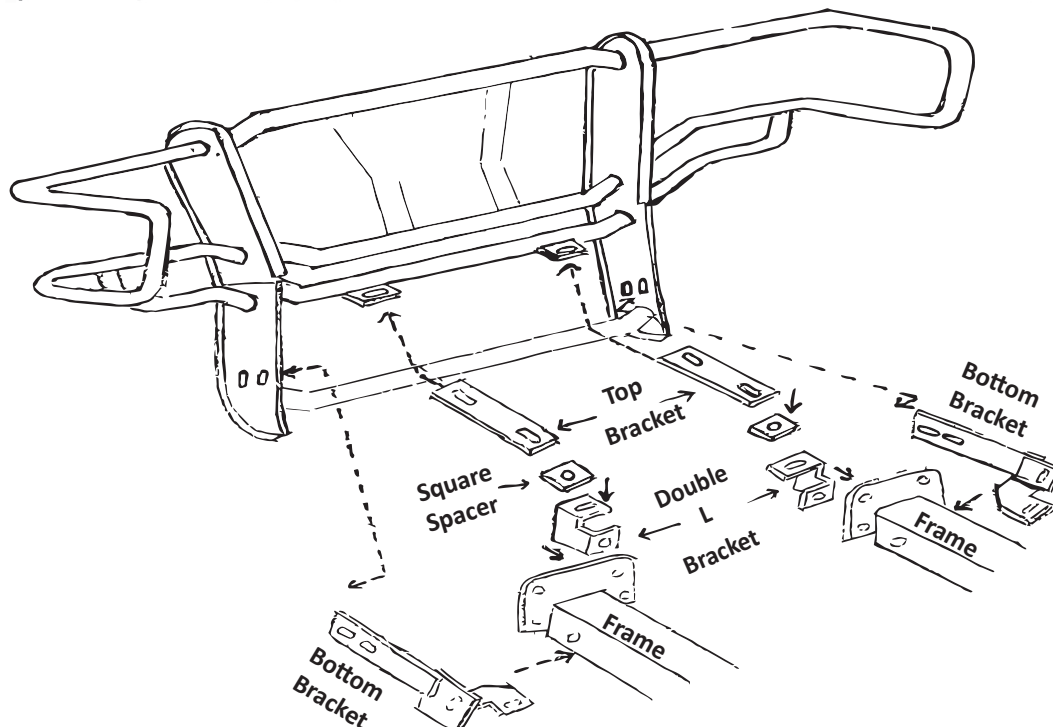

www.cattlemanhd.com

