

CATTLEMAN INSTALLATION SHEET

2017 FORD F-250/350 WRAP

#1357P

- 4 - 1/2 X 2 1/2 BOLTS
- 2 - 1/2 X 1 1/2 BOLTS
- 6 - 1/2 NUTS
- 6 - 1/2 LOCK WASHERS
- 12 - 1/2 FLAT WASHERS

Step 1 Remove the plastic cover that goes around the tow hooks.

Step 2 The factory bumper has 4 bolts on each side. Remove the 2 outside bolt ONLY.

Step 3 Put the inside support bracket, remove 2 - bolts on the side of the frame that holds the frame bottom factory bracket. You may need to use a clamp on the factory frame bracket to keep the bracket from opening. Use same factory bolts for the support bracket.

Step 4 Make a cut out on the bottom plastic for the bottom grill guard strap as shown.

Step 5 Put grill guard in place and bolt on. Check alignment on grill guard and tighten bolts.

Step 6 Once the grill guard is in place you can put the tow hook plastic cover back on. You would need to trim it in order for it to fit . You may need to periodically re tighten the bolts.

Passenger Side

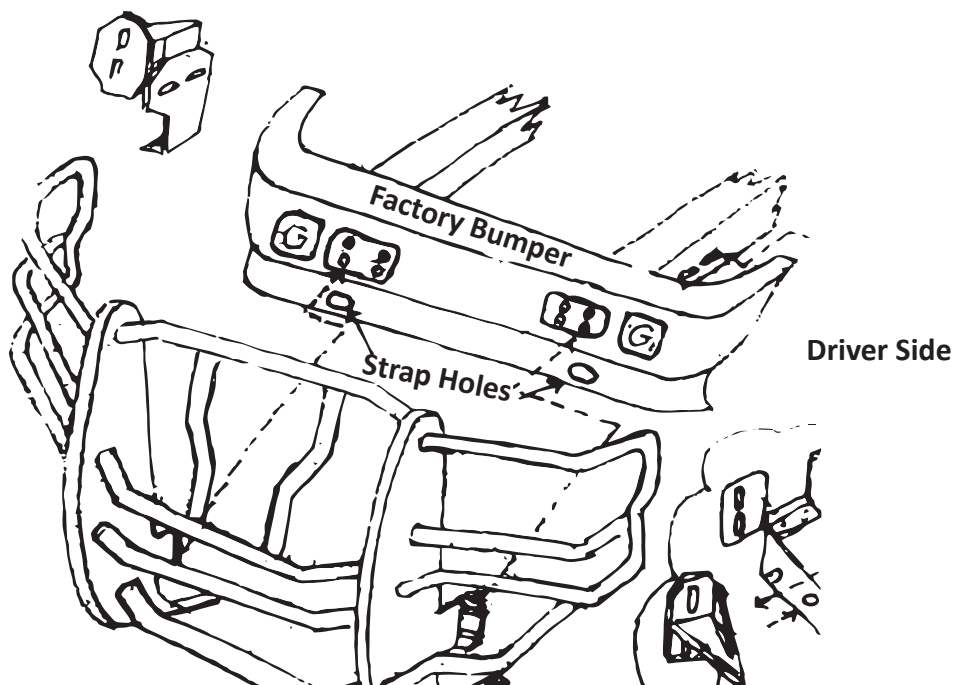

Driver Side

www.cattlemanhd.com

