

CATTLEMAN INSTALLATION SHEET

94-02 DODGE 2500/3500

PART # 1210

94-01 DODGE 1500

BOLTS:

2- 1/2 X 3"

6- 1/2" LOCK WASHER

4- 1/2 X 1 1/2"

12- 1/2" FLAT WASHER

6- 1/2" NUT

Step 1: Place "L" brackets on the cross member as shown:

Step 2: Place grille guard under the "L" bracket and bolt as shown.

Step 3: Center grille guard to the front end of the truck. Place "C" bracket inside the air vent hole and bolt with a 1/2 x 3" bolt as shown.

UPRIGHT GRILLE GUARD MOUNT

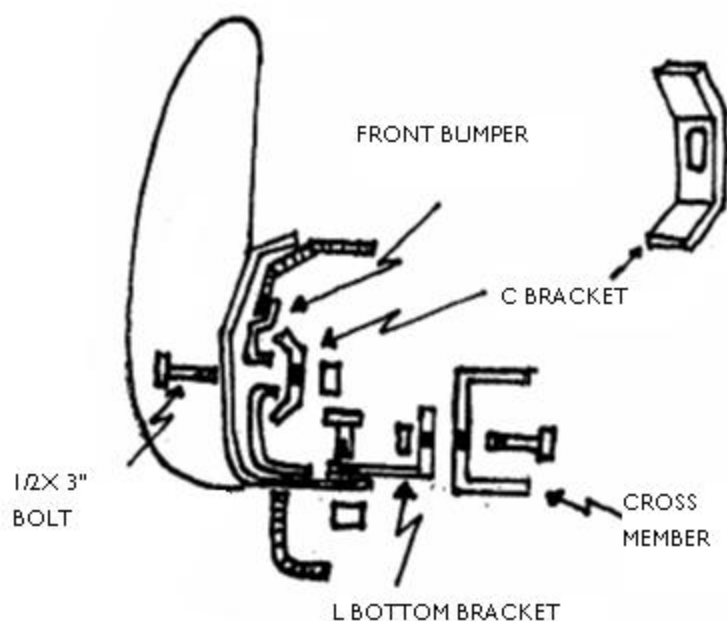

"L" BRACKET MOUNT

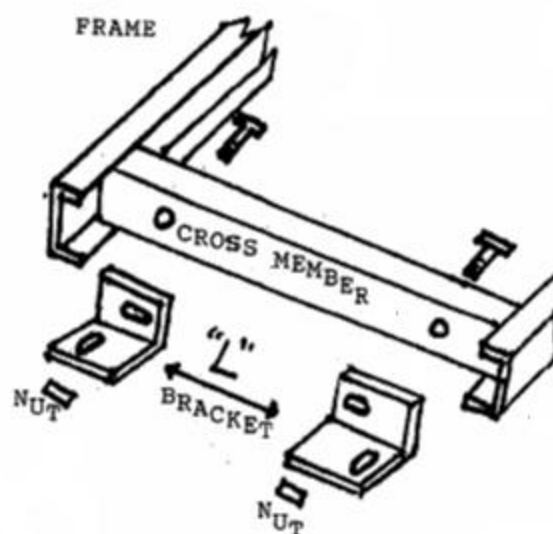

www.cattlemanhd.com

