

# CATTLEMAN INSTALLATION SHEET

07-10 CHEVY 1/2 TON WRAP

PART # 1150

## INSTALLATION WRAP

1- 1/2 X 5" BOLT  
12- 1/2 X 2" BOLT  
2- 1/2 X 1 1/2" BOLT  
15- 1/2" NUT  
15- 1/2" LOCK WASHER  
30- 1/2" FLAT WASHER

Step 1: Remove factory tow hook bolts. Place passenger brackets on the outside of frame.

Step 2: Place offset bracket on the driver side, on the side of the frame, then place driver bracket on the outside of frame as shown.

Step 3: Remove inside top factory bolt, place "Z" bracket as shown and bolt on with same factory bolt.

Step 4: Put grille guard in place bolt on the bottom bracket and then on the top flat brackets, as shown.

Step 5: Check alignment on the grille guard and tighten bolts.

Step 6: You may need to periodically retighten the bolts.

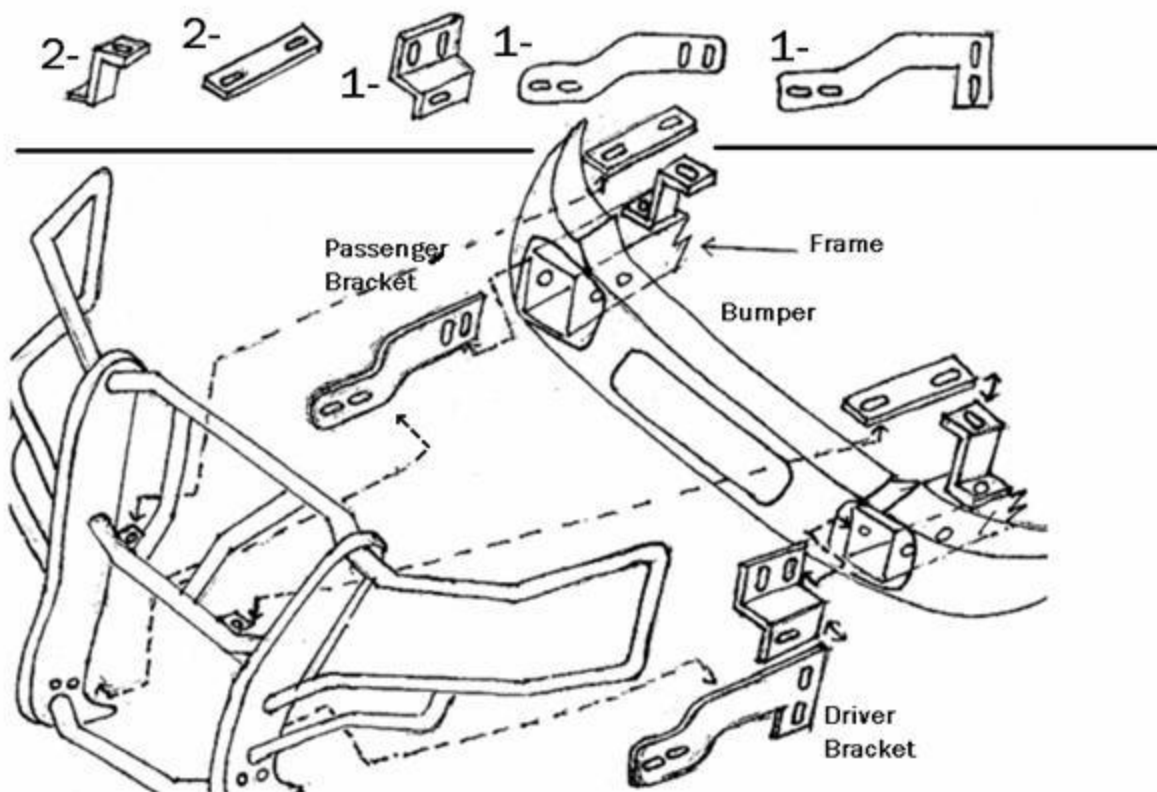

[www.cattlemanhd.com](http://www.cattlemanhd.com)

